

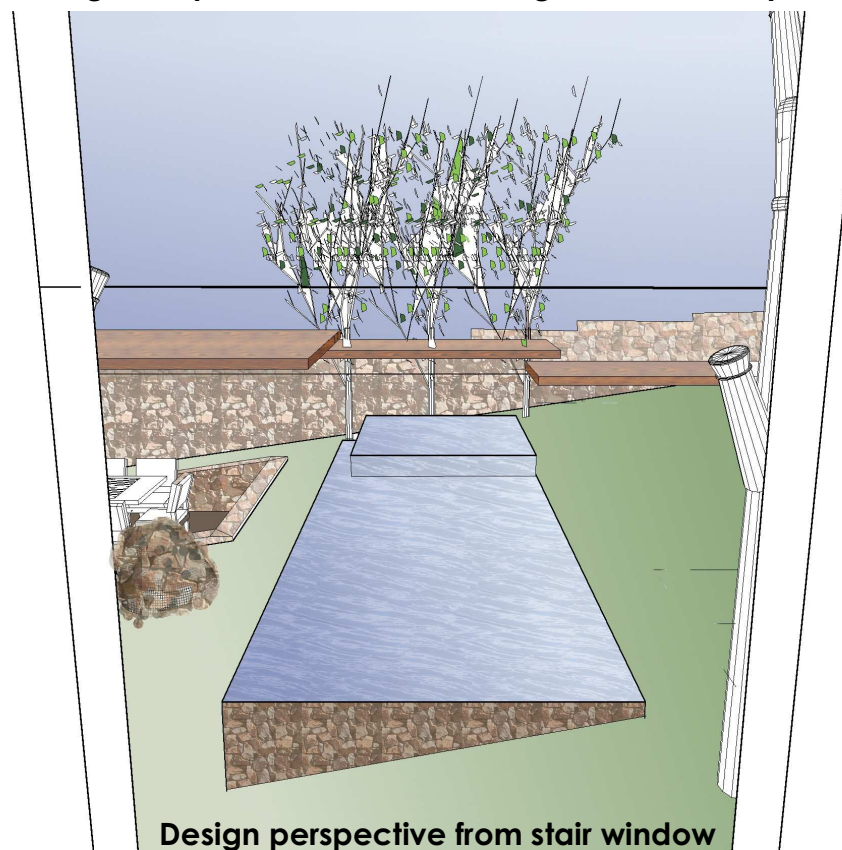

Design Perspective of sunken lounge & rim flow beyond



Design perspective from stair window

Entertainment terrace and viewing deck on a steep urban site, designed to create a fully functioning and autonomous entertainment area. The steep site was terraced to provide a number of levels - a sunken terrace with braai cut into the natural rock formation, covered by a viewing deck above, with the water flow from the rim flow pool including a jacuzzi section behind the sunken lounge on an intermediate level, and a tanning lawn to the north on the sunniest part of the site, with flanking outdoor shower and urinal. The toilet and steam room block provide privacy from the neighbour and support for the viewing deck. The pool is positioned to be seen on axis from the double volume glass window off the multilevel stair of the house, thus bringing water reflections into the house.

project: HILL TERRACE & GARDEN

architects and garden designers

GROWING BUILDINGS BUILDING GARDENS

greenbrick

Design cc

ck 2006/185347/23